

syitren

CALTUS

INSTRUCTIONS



WWW.SYITREN.CN

Safety Instructions

Read and understand this entire manual before using this product. Keep these instructions for future reference.

1. Do not use this product near water.
2. This product should be operated only by the type of power source indicated on the marking label or in this instruction manual.
3. Do not defeat the safety purpose of the polarized plug. A polarized plug has two blades with one blade wider than the other. This plug will fit into the power outlet only one way. If you are unable to insert the plug fully into the outlet try reversing the plug. If the plug should still fail to fit, contact your electrician.
4. Protect the power cord from being walked on or pinched particularly at plugs, convenience receptacles, and the point where they exit from the product.
5. Do not overload wall outlets, extension cords, or integral convenience receptacles as this can result in a risk of fire or electric shock.
6. Never push objects of any kind into this product through openings as they may touch dangerous voltage points or short-out parts that could result in a fire or electric shock. Never spill liquid of any kind on the product.
7. Do not attempt to service this product yourself as opening or removing covers may expose you to dangerous voltage or other hazards. Refer all servicing to qualified service personnel.
8. Changes or modifications to this unit not expressly approved by the party responsible for compliance could void the user's authority to operate the equipment.
9. Do not use attachments not recommended by the product manufacturer as they may cause hazards.
10. A product and cart combination should be moved with care. Quick stops, excessive force, and uneven surfaces may cause the product and cart combination to overturn.
11. Slots and openings in the cabinet are provided for ventilation and to ensure reliable operation of the product and to protect it from overheating. Do not block or cover these openings.
12. Unplug the product during lightning storm or when unused for long periods of time.

Items in this package

Before throwing away any packaging materials, please check thoroughly and make sure you find the following items that come along with this package:

- Turntable
- 45 RPM adapter
- 3.5mm auxiliary to RCA cable
- USB cable
- Power adaptor

Please contact Crosley customer service if there is any accessory missing from the package. **Retain the original packaging materials for exchange or return purposes.**

Specifications

Power	AC power adaptor, DC output 12 V 0.5 A
Power consumption	12W
Speaker	3"x5", 8 Ω , 5 W x 2
Turntable speed	33 $\frac{1}{3}$, 45, 78 RPM
Replacement needle	Crosley NP7

Note:

- *Design and specifications are subject to change without notice.*
- **To help save power consumption, some models will comply with ERP energy saving standard. When there is no audio input for 20 minutes, their powers will automatically cut-off. To turn power back on and resume playing, you will need to turn off the power and turn it on again.**

Product Description

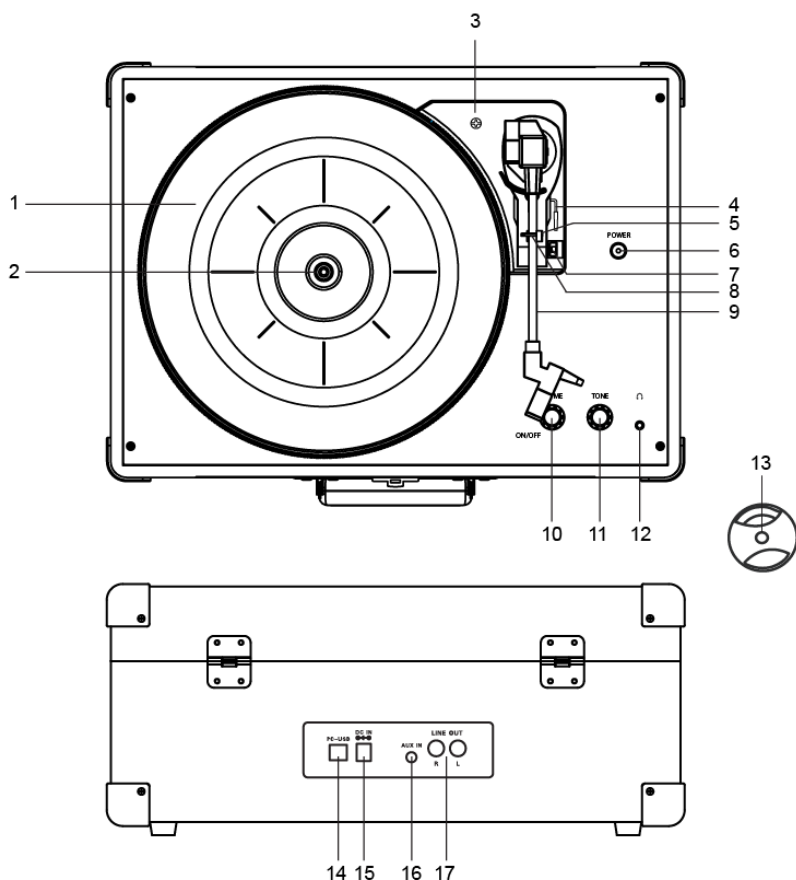

1. Turntable Platter
2. Turntable Spindle
3. Turntable Suspension Screw
4. Tonearm Lever
5. Tonearm Rest
6. Power Indicator
7. Speed Switch
8. Hold Down Clip
9. Tonearm

10. On/Off-Volume Knob
11. Tone Control
12. Headphone Jack
13. 45 RPM Adapter
14. USB Jack
15. Power Jack
16. Aux In Jack
17. RCA Jacks

Initial Setup

Essential Setup

1. Place the unit on a flat and level surface. The selected location should be stable and free from vibration.
2. Remove the tie-wrap that is holding the tonearm.
3. Rotate the **Turntable Suspension Screw** clockwise until it is all the way down. This allows the turntable to float on its shock absorbers.
4. Connect AC adaptor to the **Power Jack** of the unit.

Note: Do not plug the AC power adaptor to power outlet before all the assembly is completed. Before turning the power on, make sure again all the connection settings are correct. Always turn off the power when connecting or disconnecting.

Stereo System Connection

RCA Jacks

- The RCA Jacks output analog line-level signals and could be connected directly with a pair of active/powered speakers or the appropriate input of your stereo system.
- The Red plug connects with the Right channel and the White plug connects with the Left channel.

Note: The RCA Jacks are not designed to be connected directly to the passive/unpowered speakers. If connected to the passive speakers, the volume level will be very low.

Aux Input Connection

You can connect an audio device to this unit and play your music through its speakers. To do this, connect the 3.5mm auxiliary cable between your audio device and the **Aux In Jack** of this unit and start playing the music.

Note: The aux in connection will automatically override the turntable function. To resume using the turntable function, unplug the auxiliary cable from the aux in jack.

Turntable Operation

1. Rotate the **On/Off Volume Knob** to turn on the power.
2. Set the **Speed Switch** accordingly.
3. Place the record on the turntable. Use the **45 RPM Adapter** if necessary.
4. Remove the stylus protector from the stylus assembly.
Note: To avoid stylus damage, make certain the included stylus guard is in place whenever the turntable is being moved or cleaned.
5. Release the tonearm **Hold Down Clip**.
Note: when the turntable is not in use, remember to lock back hold down clip.
6. Use the **Tonearm Lever** to lift up the tonearm.
7. Gently move the tonearm over the record where play is desired to begin. Set the **Tonearm Lever** back to the down position, the tonearm will descend slowly onto the record and begin to playback.
8. When the record is finished playing, the tonearm will automatically return to its rest. Or to suspend the playback, use the **Tonearm Lever** again to raise the tonearm and return it to the **Tonearm Rest**. Release the lever to lower the tonearm back to its rest.
9. Lock the **Tonearm Clip** to secure the tonearm.

Needle Replacement

Removing Needle

1. Gently grasp the sides of the needle.
2. Pull needle away from the cartridge.

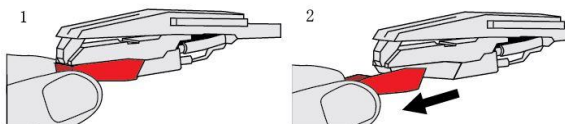

Installing Needle

1. Position the needle with its tip facing down.
2. Line up the needle with the cartridge.
3. Slide the needle onto the cartridge.

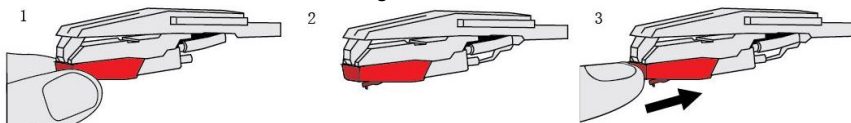

USB Recording

To record the vinyl into digital file formats such as MP3, you can use the **USB Output Jack** to connect this unit to your computer's USB port and use the recording program of your choice.

1. Use the supplied USB cable to connect the unit to your computer.
2. Turn on the power of the turntable.
3. Run the recording program of your choice.

Note:

- *In case you do not have a recording program installed, Audacity is a free software to use, distributed under the GNU General Public License (GPL). For most updated version of Audacity and instructions on how to use it, please visit Audacity website: <http://www.audacityteam.org/>. syitren would not carry responsibility or support for third party software and all downloads should be carried out at user's own responsibility.*
- *Depending on the operating system and software that you are using, you may need to make some changes on settings of the operating system and/or software before starting the recording process. As a general guideline, the recording source/input should be set to Microphone USB audio codec. And it is recommended to set it to 2 channel, 16 bit, 48000Hz (DVD Quality)*
- *Make sure the USB connection is made to the USB jack of your computer directly instead of a USB hub to ensure a successful connection.*

Turntable Maintenance

1. Do not touch the stylus tip with your fingers. Avoid bumping the stylus on the turntable mat or a record's edge.
2. Clean the stylus frequently with a soft brush with a back-to-front motion only.
3. Clean the records to get rid of dust or grease with a record cleaning brush and record cleaning solution.
4. Clean the turntable lid and turntable cabinet with a slightly damped microfiber cloth.

Note: Do not use cleanser other that contains alcohol, benzene or any other harsh chemicals, which might damage the paint and finish of the turntable.

**** syitren offers a product line of different cleaning accessories. Please ask your retailer or check out our website www.syitren.cn for more cleaning product information.**

Troubleshooting

There is no power

- Power adaptor is not connected correctly.
- No power at the power outlet.
- To help save power consumption, some models will comply with ERP energy saving standard. When there is no audio input for 20 minutes, their powers will automatically cut-off. To turn power back on and resume playing, turn off the power and turn it on again.

Power is on, but the platter does not turn

- Turntable's drive belt has slipped off.
- An aux in cable is plugged into the aux in jack, unplug it.

Turntable is spinning, but there is no sound, or sound not loud enough

- Stylus protector is still on.
- Tone arm is lift up by the lever.
- Headphone is plugged in.

FCC Statements

This equipment has been tested and found to comply with the limits for a Class B digital device, pursuant to Part 15 of the FCC Rules. These limits are designed to provide reasonable protection against harmful interference in a residential installation. This equipment generates, uses, and can radiate radio frequency energy and, if not installed and used in accordance with the instructions, may cause harmful interference to radio communications. However, there is no guarantee that interference will not occur in a particular installation. If this equipment does cause harmful interference to radio or television reception, which can be determined by turning the equipment off and on, the user is encouraged to try to correct the interference by one or more of the following measures:

- Reorient or relocate the receiving antenna.
- Increase the separation between the equipment and receiver.
- Connect the equipment into a circuit different from that to which the receiver is connected.
- Consult the dealer or an experienced radio TV technician for help.

syitren

CALTUS

使用说明书



WWW.SYITREN.CN

安全说明

在使用本产品之前，请阅读并理解本手册的全部内容。
请保存这些说明以备将来参考。

1. 请勿在靠近水的地方使用本产品。
2. 本产品只能使用本使用手册中所示的电源类型进行操作。
3. 如果你不能将插头完全插入插座，试着倒转插头。
如果插头仍未安装，请与您的厂家联系。
4. 防止电源线被人踩踏或夹伤，尤其是插头、便利插座和它们从产品出口的地方。
5. 请勿使墙上插座、延长线或整体式便利插座过载，因为这可能导致火灾或触电。
6. 切勿将任何种类的物体通过开口推入本产品，因为它们可能会接触到危险的电压点或短路部件，从而导致火灾。切勿将任何液体溅到产品上。
7. 请勿尝试自己维修本产品，因为打开或取下盖子可能会使您接触到危险电压或其他危险。请将所有维修工作交给合格的维修人员
8. 未经负责合规性的一方明确批准而对本装置进行的更改或修改可能会使用户失去操作设备的权限。
9. 不要使用非产品制造商推荐的附件，因为它们可能会造成危险。
10. 应小心移动产品和推车组合。快速停止、用力过大和表面不平可能导致产品和推车组合翻转。
11. 机柜中的槽和开口用于通风，以确保产品可靠运行并防止其过热。
不要堵住或盖住这些开口。
12. 在雷雨天气或长时间不用时，请拔掉产品插头。

包装配件

在扔掉任何包装材料之前，请彻底检查并确保您找到了本包装附带的以下物品：

- 唱片机
- RPM转换器
- 3.5转RCA音频线
- USB传输线
- 电源适配器

如果包裹中有任何配件丢失，请联系syitren客服。保留原包装材料以备交换或退货之用。

规格参数

电源	12 V 0.5 A
功率	12W
扬声器	8Ω 5w*2
Turntable speed	33 ¹ / ₃ , 45, 78 RPM
Replacementneedle	NP7

注意

- 设计和规格如有更改，恕不另行通知。
- 为了节省电力消耗，一些型号将符合ERP节能标准。当20分钟内没有音频输入时，它们的电源将自动切断。要重新打开电源并继续播放，您需要关闭电源并再次打开电源。

产品描述

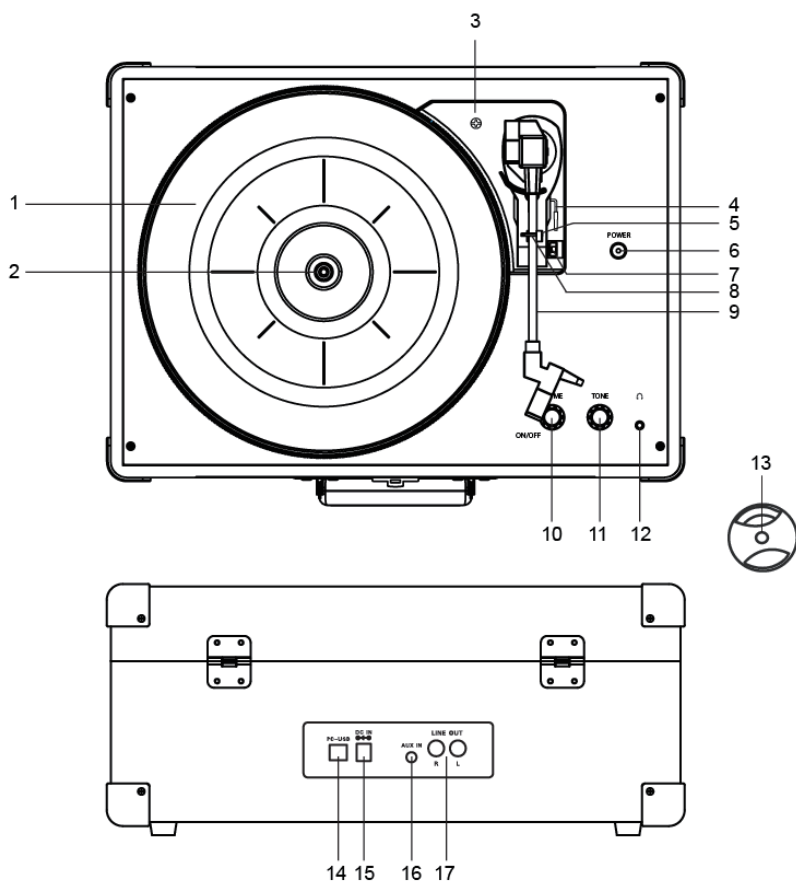

1. 转盘
2. 转轴
3. 转盘悬挂螺丝
4. 升降杆
5. 唱臂架
6. 电源指示灯
7. 转速调节
8. 唱臂锁扣
9. 唱臂

10. 开关/音量调节
11. 音调控制
12. 耳机插孔
13. RPM转换器
14. USB接口
15. 电源接口
16. AUX接口
17. RCA接口

初始设置

基本设置

1. 将装置放在平坦的水平面上。所选位置应稳定无振动。
2. 拆下固定唱臂的系带。
3. 顺时针旋转转台悬挂螺钉，直到完全向下。这使得转台能够浮在它的减震器上。
4. 将交流适配器连接到装置的电源插座上。
注意：在所有装配完成之前，不要将交流电源适配器插入电源插座。打开电源前，再次确保所有连接设置正确。连接或断开时，请务必关闭电源。

立体声系统连接

RCA接口

- RCA插孔输出模拟线电平信号，可以直接连接到一对有源扬声器或立体声系统的对应输入。
- 红色插头连接右侧通道，白色插头连接左侧通道。

注意：RCA插孔的设计并非直接连接到无电源扬声器。
如果连接到无源扬声器，音量将非常低。

Aux音频输入连接

您可以将音频设备连接到此单元并通过其扬声器播放音乐。为此，请将3.5毫米的辅助电缆连接到音频设备和本机的Aux In插孔之间，然后开始播放音乐。

注：aux in连接将自动覆盖唱片功能。要继续使用唱片功能，请从aux in插孔中拔下辅助电缆。

唱片机操作

1. 旋转开/关音量旋钮打开电源。
2. 设置转速与唱片一致。
3. 把唱片放在转盘上。如有必要，使用RPM适配器。
4. 摘下唱针保护罩。
注意：为避免唱针损坏，清洁或移动唱机时，请盖好保护罩。
5. 打开唱臂锁扣
注意：当不使用时，记得扣好锁扣。
6. 抬起唱臂升降杆
7. 轻轻地唱头移到希望开始播放的唱片上。放下升降杆。唱臂将下降慢慢进入唱片，开始播放。
8. 当唱片播放完毕后，唱臂将自动返回到唱臂架。要暂停播放，请再次抬起升降杆，将唱臂放回唱臂架后，放下升降杆。
9. 关闭锁扣，固定好唱臂

更换唱针

拆下唱针

1. 轻轻地抓住针的两侧。
2. 将针从唱头上取下。

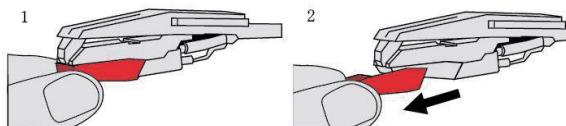

安装唱针

1. 将针头朝下放置。
2. 将唱针与唱头对齐。
3. 将针滑到墨盒上

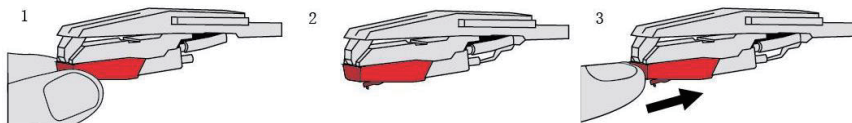

USB转录

要将唱片音乐录制成MP3等数字文件格式，您可以使用USB输出插孔将该单元连接到计算机的USB端口，并使用您选择的录制程序。

1. 使用提供的USB数据线将设备连接到计算机。
2. 打开唱片机电源。
3. 运行你选择的录制程序。

注意：

- 如果您没有安装录制程序，Audacity是一个免费软件，有关Audacity的最新版本及其使用说明，请访问Audacity网站：<http://www.audacityteam.org/>。
本公司不提供第三方软件，所有下载由用户自己负责。
- 根据您使用的操作系统和软件，在开始录制过程之前，您可能需要对操作系统和/或软件的设置进行一些更改。一般来说，录音源/输入应设置为麦克风USB音频编解码器。
建议设置为2通道，16位，48000Hz（DVD质量）
- 确保USB连接直接连接到计算机的USB插孔，而不是USB集线器，以确保连接成功。

唱片机维护

1. 不要用手指触摸触针尖。避免唱针触碰转盘垫子或唱片边。
2. 经常用软刷清洁唱针，只允许前后移动。
3. 用唱片清洁刷清洁唱片以除去灰尘。
4. 用稍微潮湿的超细纤维清洁唱片机。

注意：不要使用含有酒精、苯或任何其他刺激性物质的清洁剂可能会损坏转台油漆和饰面的化学品。

**syitren提供各种清洁配件的产品线。请咨询您的零售商或查看我们的网站www.syitren.cn了解更多清洁产品信息。

故障排除

不通电

- 电源适配器没有正确连接
- 电源插座没有电
- 为了帮助节省电力消耗，一些型号将符合ERP能源保存标准。当他们的声音没有输入时，20分钟将自动切断。要重新打开电源并继续播放，请关闭再打开电源。

电源已正常连接，但是唱盘无法转动

- 唱片机皮带脱落。
- AUX接口如插入音频线，请将其拔出。

唱盘在转动，但是没有声音或声音不够大

- 确保已经取下唱针保护罩。
- 确保升降杆没有抬起。
- 可能插入耳机。

FCC声明

本设备经过测试，符合B类数字设备的限制，根据FCC规则第15部分。这些限制旨在提供合理的保护防止住宅设施中的有害干扰。这种设备产生、使用并能够辐射射频能量，如果未按照说明安装和使用，则对无线电造成有害干扰通信。但是，不能保证在特定情况下不会发生干扰。如果这个设备对无线电造成有害干扰，这可以通过关闭和打开设备来确定，尝试通过以下一项或多项措施纠正干扰：

- 重新定位或重新定位接收天线。
- 增加设备和接收器之间的距离。
- 将设备连接到与接收器连接的电路不同的电路中。
- 咨询经销商或经验丰富的广播电视技术人员寻求帮助。

